

## Sfiatch free flow version made of brass conical thread

BODY MATERIAL Brass

(1) PROTECTION CAP White Zinc-plated Steel

## DESCRIPTION

The breather plug is designed to maintain at atmospheric pressure a unit even when it is under sudden changes in ambient temperature. This model is not filtered and permits a free flow of air. The cap protects from foreign bodies which may enter into the mechanical equipment and may cause damages.

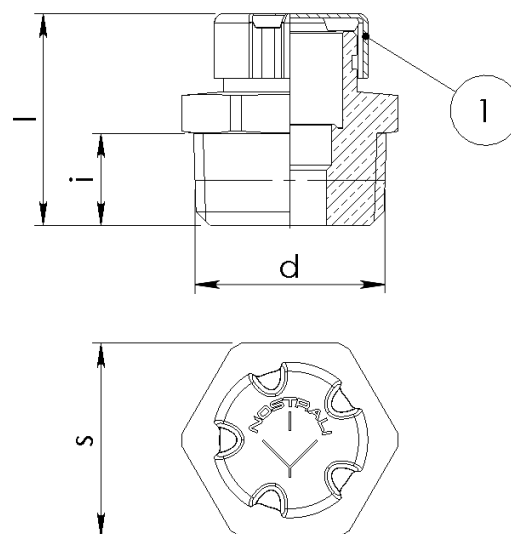
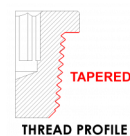

Article	d	i[mm]	s[mm]	l[mm]	weight[g]
130100175	R 1/4	10	14	20,5	15
130100176	R 3/8	10	17	22,5	24
130100177	R 1/2	10	21	23	39