

Breather plug labyrinth version made of aluminium alloy

BODY MATERIAL Aluminium alloy**(1) PROTECTION CAP** White Zinc-plated Steel**(2) LABYRINTH** Aluminium alloy**DESCRIPTION**

The breather plug (or breather cap) is designed to maintain at atmospheric pressure a unit even when it is under sudden changes in ambient temperature, or in oil temperature. This model has an internal labyrinth that prevents oil loss. It is particularly suitable for use where oil is violently agitated and could be splashed against the cap. The cap protects from foreign bodies which may enter into the mechanical equipment and may cause damages.

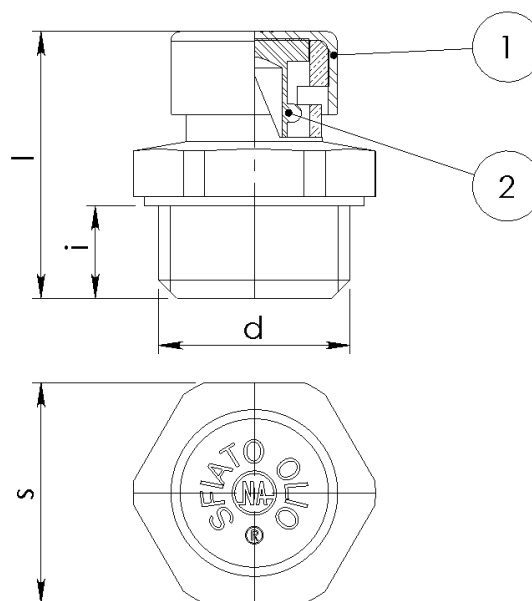
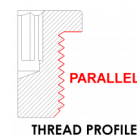

Article	d	i[mm]	s[mm]	l[mm]	weight[g]
130200058	G1/4	9	17	29	13,5
130200059	G 3/8	9	20	28	17
130200060	G 1/2	10	24	29	23,5
130200008	G 1/2	10	27	33	23
130200061	G 3/4	12	32	35,5	41,5
130200062	G 1	13,5	40	43	72
130200004	M14X1,5	8,5	19	27	10
130200050	M18X1,5	9	22	28	19,5
130200005	M20X1,5	10	24	32	25
130200054	M22X1,5	10	27	30	31,5
130200052	M30X2	12	36	35,5	65,5