

Breather plug bronze sinterized filter version made of aluminium alloy

BODY MATERIAL Aluminium alloy**(1) PROTECTION CAP** White Zinc-plated Steel**(2) LABYRINTH** Aluminium alloy**(3) FILTER** Bronze Spheres 50 mc**DESCRIPTION**

The breather plug is designed to maintain at atmospheric pressure a unit even when it is under sudden changes in ambient temperature. This model has an internal filter which prevents oil loss and avoids entrance of dust. The cap protects from foreign bodies which may enter into the mechanical equipment and may cause damages.

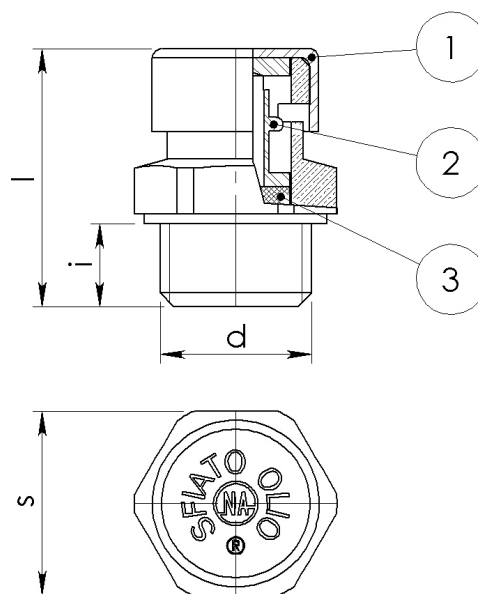
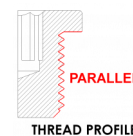

Article	d	i[mm]	s[mm]	l[mm]	weight[g]
130300032	G1/4	8	17	24	10
130300042	G 3/8	9	20	28	18,5
130300012	G 1/2	10	27	33	25
130300044	G 3/4	12	32	35	64,5
130300015	G 1	13,5	40	43	84,5
130300046	G 1 1/4	15,5	50	55	184
130300004	M14X1,5	8,5	19	27	19
130300006	M20X1,5	10	24	32	25