

Drain cock with lever

BODY MATERIAL Brass

RANGE TEMPERATURE -10 +80 [°C] ; +14 +194 [F]

DESCRIPTION

Condensate drain valve. The sealing system is guaranteed by an internal O-Ring. Ample possibilities for customising sealers, materials and design geometry.

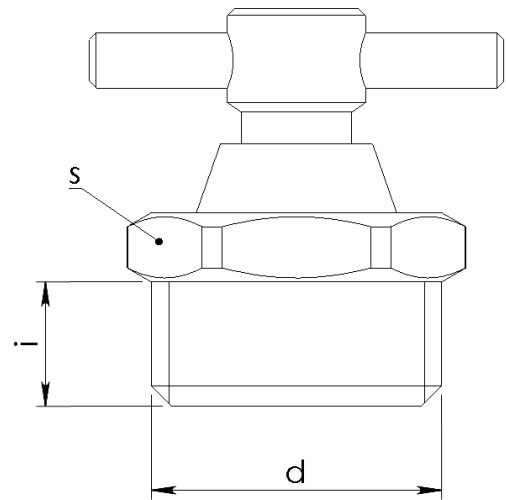
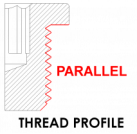

Article	d	i[mm]	s[mm]
420200008	G 3/8	7,5	17
420200009	G 1/2	9	22